

# *Sapling Grove Apartments*

## **Bristol, Virginia**



Available Early 2008  
 Call Diana Carter – (276) 821-6256

### ***Features and Facts***

- ❖ Built in 2007
- ❖ 26 duplex garden style units
- ❖ Brick foundation
- ❖ Open dining area
- ❖ Ample closet space
- ❖ Tiled kitchen
- ❖ Garbage disposal
- ❖ Washer and dryer
- ❖ Central heating
- ❖ Dishwasher and range
- ❖ Refrigerator
- ❖ Municipal water/sewer
- ❖ Convenient washer/dryer hookups
- ❖ Energy-efficient electric water heater
- ❖ Deadbolts on all entrances

- ❖ Large master bedroom
- ❖ Universal design and accessibility standards used
- ❖ Parking adjacent to each unit
- ❖ Covered private porch
- ❖ 1 & 2 bedroom units

### ***Other Information***

- ❖ 1BR/1BA – 776 sq. ft.
- ❖ 2BR/1BA – 985 sq. ft.

### ***Income Limits***

<u>Person</u>	<u>Limit</u>
1	19,560
2	22,320
3	25,140
4	27,900

### ***Other Amenities***

- ❖ Within walking distance to Downtown Bristol
- ❖ Close to City parks, museums, and public library
- ❖ On City bus route

### ***Costs***

- ❖ 1BR – monthly rent \$355
- ❖ 2BR – monthly rent \$420



### Location Map

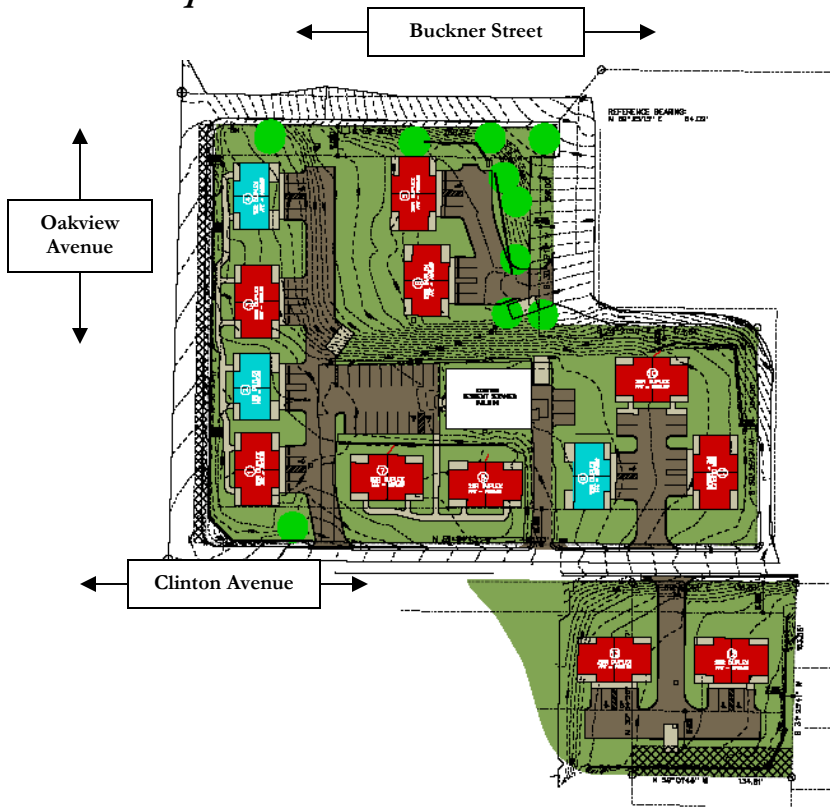

### Floor plan (2 bedroom)

