

Sapling Grove Apartments

Bristol, Virginia



Now Taking Applications
Must Make Appointment to Apply
Call Pat Tignor for Appointment 276 821-6257

Features and Facts

- ❖ Built in 2007
- ❖ 26 duplex garden style units
- ❖ Brick foundation
- ❖ Open dining area
- ❖ Ample closet space
- ❖ Tiled kitchen
- ❖ Garbage disposal
- ❖ Washer and dryer
- ❖ Central heating
- ❖ Dishwasher and range
- ❖ Refrigerator
- ❖ Municipal water/sewer
- ❖ Convenient washer/dryer hookups
- ❖ Energy-efficient electric water heater
- ❖ Deadbolts on all entrances

- ❖ Large master bedroom
- ❖ Universal design and accessibility standards used
- ❖ Parking adjacent to each unit
- ❖ Covered private porch
- ❖ 1 & 2 bedroom units

Other Information

- ❖ 1BR/1BA – 776 sq. ft.
- ❖ 2BR/1BA – 985 sq. ft.

Income Limits

<u>Person</u>	<u>Limit</u>
1	20,820
2	23,760
3	26,760
4	29,700

Other Amenities

- ❖ Within walking distance to Downtown Bristol
- ❖ Close to City parks, museums, and public library
- ❖ On City bus route

Costs

- ❖ 1BR – monthly rent \$375
- ❖ 2BR – monthly rent \$444

Location Map

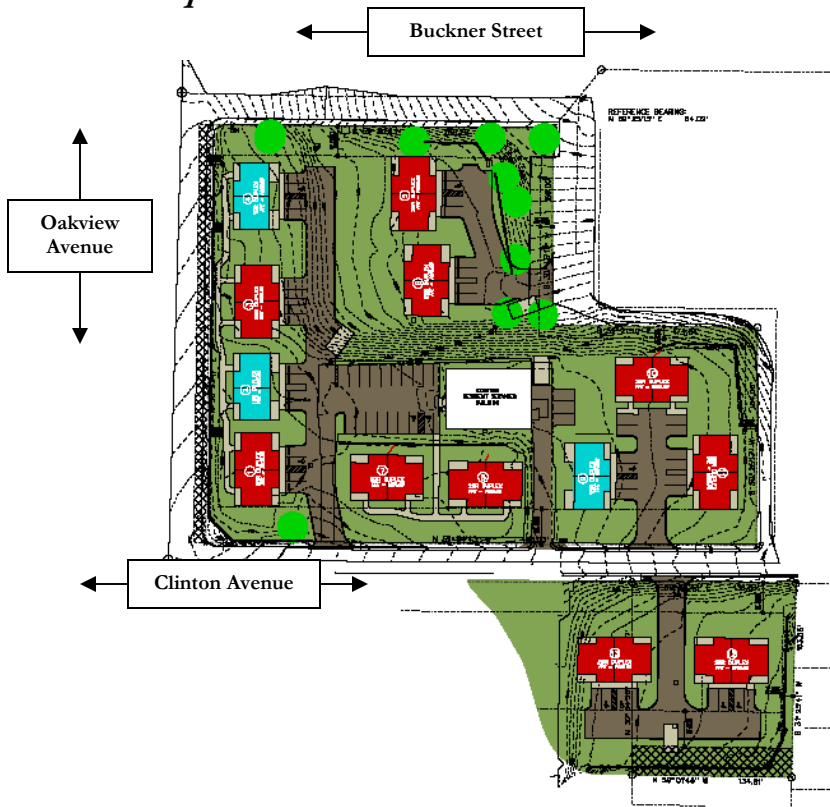

Floor plan (2 bedroom)

